

# HIP-MITSU

equipment & turn-key lines  
for hot melt adhesive application

add value to your production

## TURN-KEY SOLUTIONS FOR LABEL PRINTERS

How to reduce production costs and obtain labels with a high added value?

- 1. Considerable reduction of production costs and wastes*
- 2. Adhesive application only where required : a big advantage*
- 3. Outstanding increase of label customisation*
- 4. Production of labels with a high added value*

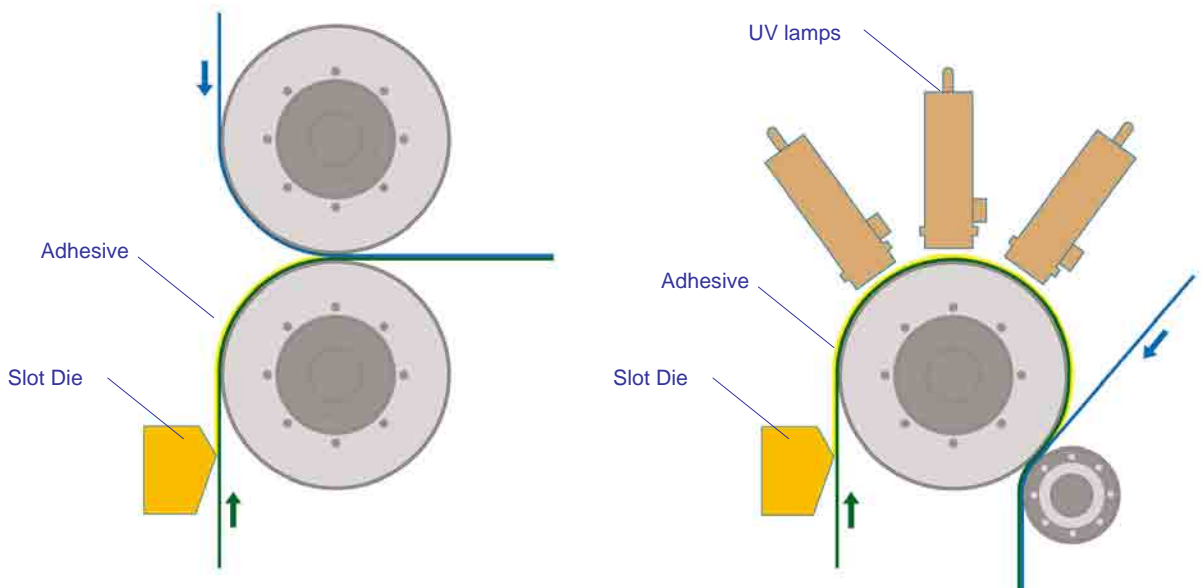

# WANT TO LAMINATE / TO COAT HIGH VALUE-ADDED PRODUCTS?

*It's easy with the HIP-MITSU turn-key solutions: equipment, machines and systems for the application of hot melt adhesives, UV and PUR too.*

## The Company – innovation and steady research

HIP-MITSU, Italian company headquartered 15 minutes from the international Venice and Treviso airports, is one of the most qualified producers of Web-Coating and Web-Laminating equipment, machines and systems, in a field it has operated in for many years and where holds many international patents.

## Application range : performances

The typical *working range* is referable to the following parameters: *coating width* from **0,3 to 6.000 mm**; *high or low line speed*, according to the end user's working process, with applications from **2 up to 900 m/min**; *coating weight* from **0,02 to 1.500 gr/sqm**, *working temperature* up to **240°C**, *viscosity* up to **120.000 mpas**.

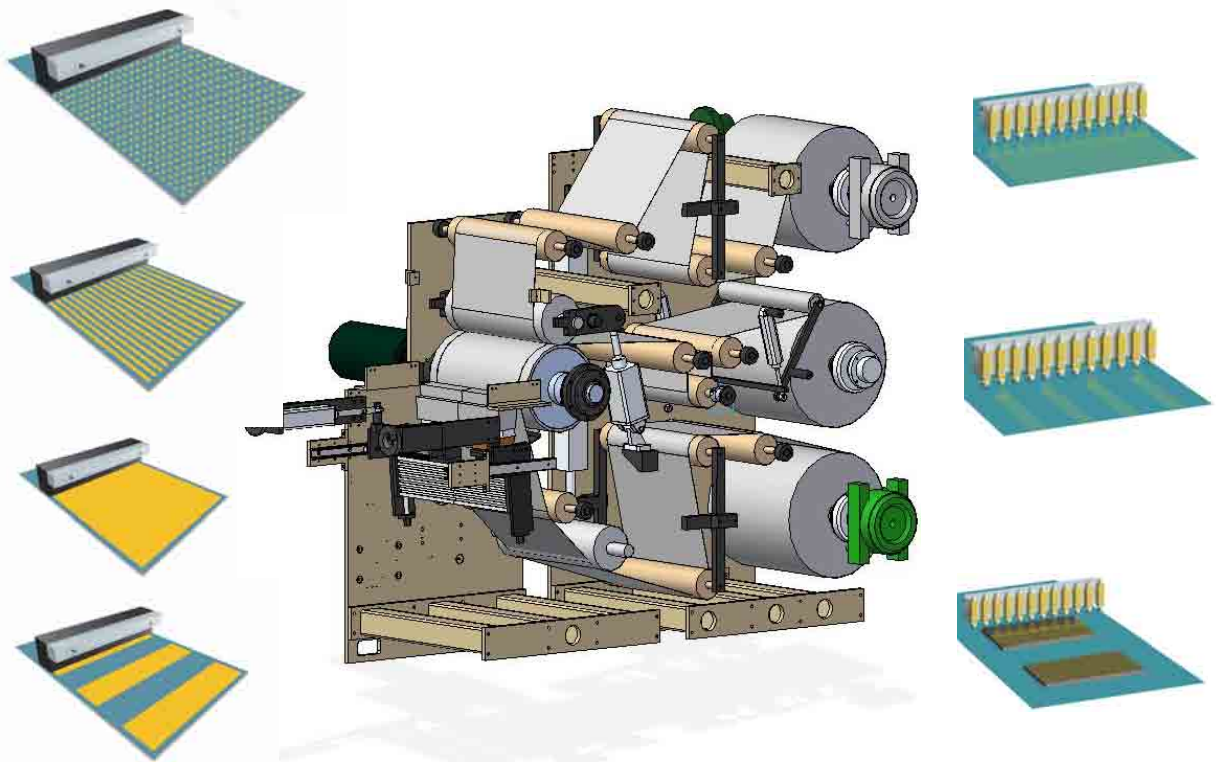

## Product range : coating and laminating systems, equipment and lines

- Slot dies for hot melt adhesives
- Single and multiple automatic guns for hot melt adhesives contact-less application
- Continuous output melting units for hot melt adhesives
- Drum melters for hot melt adhesives
- Low speed Calenders/Web-Coaters for hot melt adhesives – for materials in rolls
- Low speed Calenders/Web-Coaters for hot melt adhesives – for materials in slabs
- Low speed Web-Coating/Web-Laminating lines for hot melt adhesives
- High speed Calenders/Web-Coaters for hot melt adhesives

- High speed Web-Coating/Web-Laminating lines for hot melt adhesives

## Retrofit of existing coating a/o laminating systems – a turn-key service

All HIP-MITSU systems can be *easily installed* both into a *new* and into an *existing line*; in this last case results are *considerable increasing* of the *machine performances* and *production costs saving*. All services offered by HIP-MITSU for the plant re-engineering and for the installation are listed into the specific section.

# SLOT DIE for SELF-ADHESIVE LABELS

The HIP-MITSU's Web-Coaters for hot-melt and UV curable adhesives enable a precise and accurate adhesive application onto the surface of the substrate, both before and after the printing process or onto the liner. The Web-Coaters can be installed within a limited space and enable a wide range of applications such as those represented below. As they do not work in contact with any cylinder, no adjustment is required so coating width variations can take place within a few minutes. The Web-Coaters are fully synchronised with the main line leading to no contamination of the main line.



Adhesive's application

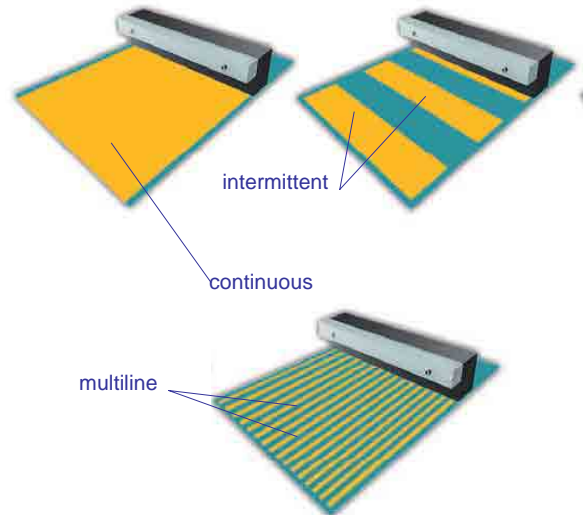

adhesive

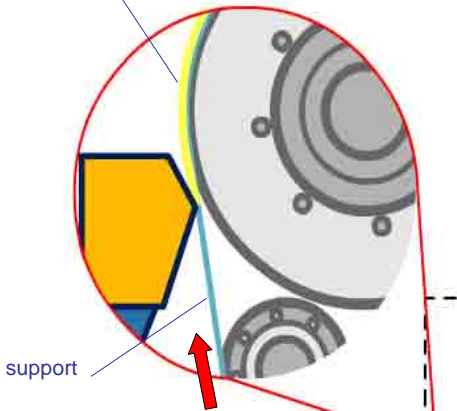

support

Some examples of adhesive patterns

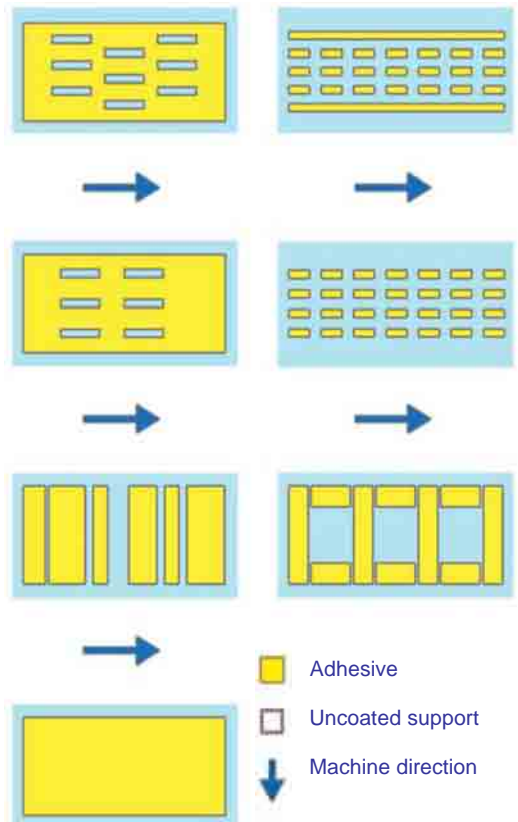

Web-Coater : available working positions

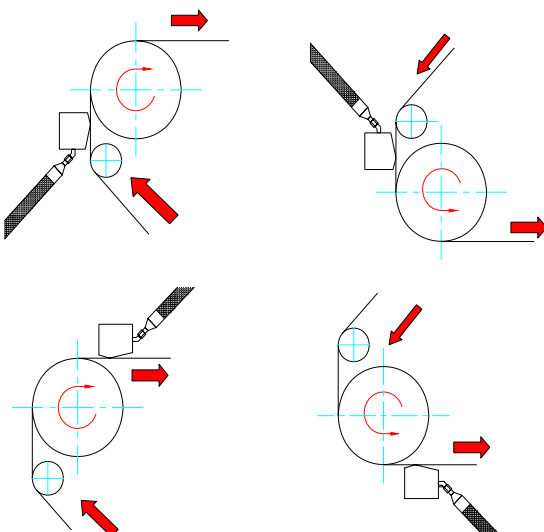

# WEB-COATER : “Off - Line” SOLUTION

HIP-MITSU's “Off-line” Web-Coaters are used for the application of hot-melt and UV curable adhesives. Included with the Web-Coater are hoses and melting units (with continuous output or for drums), laminator, web-guide, winders and re-winders with pneumatic expanding shaft with a diameter of 3”. The machine incorporates tension control for rolls to be processed. Motorization from left or right side, a user friendly centralised control panel enables easy and efficient management of the plant. UV lamps of any brand can be installed also at a later date.



Example of an integrated solution for hot melt adhesives

Example of an integrated solution for UV curable adhesives

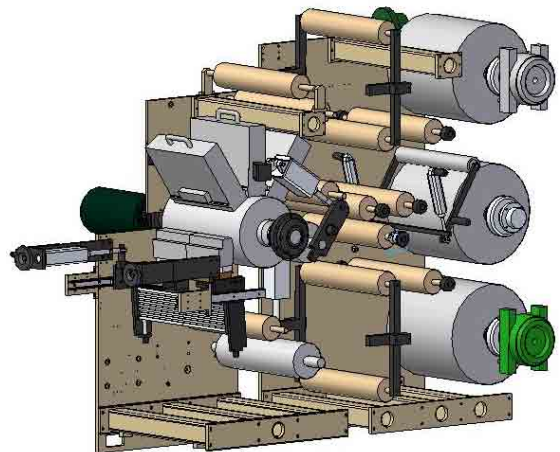
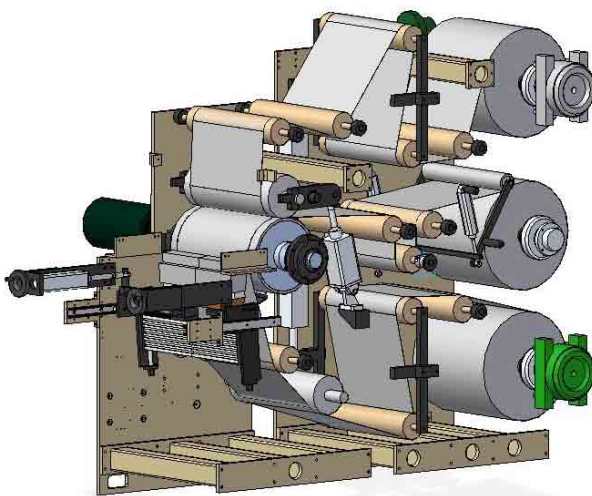

# WEB-COATER : “On - Line” SOLUTION

HIP-MITSU's "Online" Web-Coaters for hot-melt and UV curable adhesives can be easily installed on existing and new printing machines for producing self-adhesive labels. Available in all the usual web widths used on printing machines and employed for the online adhesive application of printed labels. Fitted are handy eyebolts for easy transportation and positioning. They are supplied complete with Web-Coater, hoses and melting units (with continuous output or for drums), motorization left or right side and tension control for the rolls to be processed. A user friendly central control board enables an easy and efficient management of the plant. UV lamps of any brand can be installed also at a later date.

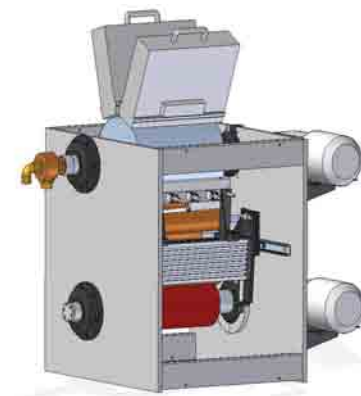
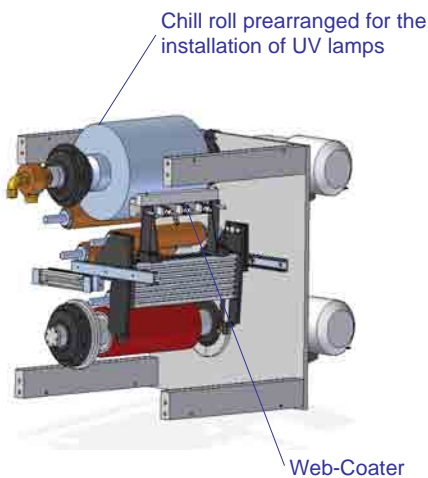

Web-Coater : integrated solution complete of UV lamps

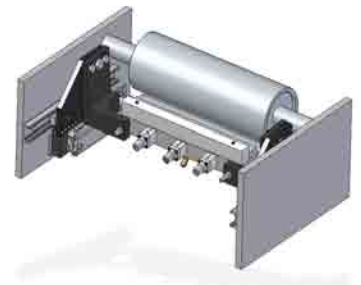

Web-Coater : compact solution for hot melt adhesives

# MELTERS for HOT MELT ADHESIVES

## CONTINUOUS OUTPUT MELTING UNITS

All HIP-MITSU CONTINUOUS OUTPUT melting units enable the use of HOT MELT – also PUR and UV curable - adhesives, in chips or in blocks.

A wide range of models, all equipped with HIGH PRECISION GEAR PUMPS, meets all application needs starting from a 2,5 up to 1.000 kg/hour MELT RATE.

The standardized and integrated design enables an EXTREMELY EASY USE combined with a QUICK and SIMPLE INTERFACE to the main printing machine.



## DRUM MELTERS – model DM 200 and DM 55

HIP-MITSU drum melters can process HOT MELT – also PUR and UV curable – adhesives. Model DM 200 for 200 liters drums and model DM 55 for 55 gallons drums.

### DRUM MELTERS – model DM 20 and DM 5

HIP-MITSU drum melters can process HOT MELT – also PUR and UV curable – adhesives. Model DM 20 for 20 liters drums and model DM 5 for 5 gallons drums.

All models are equipped with HIGH PRECISION GEAR PUMPS.

The standardized and integrated design enables an EXTREMELY EASY USE combined with a QUICK and SIMPLE INTERFACE to the main printing machine.



Model DM 20 and DM 5



Model DM 200 and DM 55

## USER FRIENDLY MITSU SYSTEM

All HIP-MITSU melters can be equipped with the MITSU USER FRIENDLY system to allow high levels of FLEXIBILITY joined to an EXTREMELY EASY USE thanks to a simultaneously digital setting of the coating weights.

Moreover the MITSU USER FRIENDLY system enables to produce NO WASTE and therefore makes SUBSTANTIAL SAVINGS in the PRODUCTION COSTS.

Working width (mm)	320
Adhesive Set Value (gr/sqm)	3,10
Adhesive Real (gr/sqm)	3,11
Line Speed (m/min)	310

# GENERAL SERVICES

## **Competence Center – Production Lines for tests execution**

The HIP-MITSU *Competence Center*, equipped with the most advanced technologies and *production lines*, helps Customers during the application development enabling adhesive, polymers and materials testing.

Free Demo in real production's conditions are available every day on HIP-MITSU equipment, lines and systems.

## **A full assistance to customers during each phase of the project**

- *Polymer/Adhesive's research*
- *Sampling*
- *Project Engineering*

## **Training Courses for end users**

HIP-MITSU offers to its Customers complete training courses including both theoretical and practical sections.

Full papers - available in five languages - are supplied at each course to all participants.

Courses available for: *line operator; mechanical maintenance staff; electrical maintenance staff.*

## **Periodical Maintenance Service**

Complete programs of periodical maintenance, which can take place both at HIP-MITSU and customer's site.

## **Spare Parts**

HIP-MITSU spare parts service avails itself of the main international couriers ensuring spare parts delivery the day after the order receipt

## **A worldwide sales network**

HIP-MITSU is worldwide locally present with a network of highly skilled professionals, who ensure a quick and qualified answer.



## **First Installation and Technical Assistance**

HIP-MITSU technical assistance service is held by a team of skilled English-speaking technicians operating worldwide for many years, who ensures a highly professional support both during the installation and the technical assistance.

HIP-MITSU working team includes: process engineers; mechanical maintenance staff; electrical maintenance staff; electronic maintenance staff; PLC software technicians; PC software technicians.

## **HIP-MITSU: a "Cappuccino" Idea**

HIP-MITSU technology is really a "cappuccino" idea : as milk adds value to a coffee cup, so it adds value to the roll goods produced by the end user.



*add value to your production*

### **HEAD OFFICE**

I - 31027 SPRESIANO (TV) Italy - Via A. Volta, 1  
Tel. + 39 0422 887.566 r.a. - Fax + 39 0422 887.337 - <http://www.hip-mitsu.com> e-mail: [info@hip-mitsu.com](mailto:info@hip-mitsu.com)